

DIANNE D. MILLER

Admitted in Colorado
and New Mexico

MONICA A. ROSENBLUTH

Admitted in Colorado, New Mexico
and Wyoming



ATTORNEYS AT LAW

65113

MATTHEW P. RUHLAND

Admitted in Colorado

BRADLEY T. NEIMAN

Admitted in Colorado
and Georgia

December 20, 2010

Division of Local Government
1313 Sherman Street
Room 521
Denver, CO 80203

RE: Landis Creek Metropolitan District Nos. 1 & 2
Map of District Boundaries

To Whom It May Concern:

Attached are the current maps of the boundaries of the above captioned districts.
Please contact us with any questions or for additional information.

✓
KEA

Very truly yours,

MILLER ROSENBLUTH, LLC

Matthew Ruhland
Attorney

Enclosure

METROPOLITAN DISTRICT AREAS
 Landis Creek Metropolitan District #1
 (Financing District) 5908.54 acres

Landis Creek Metropolitan District #2 2.61 acres

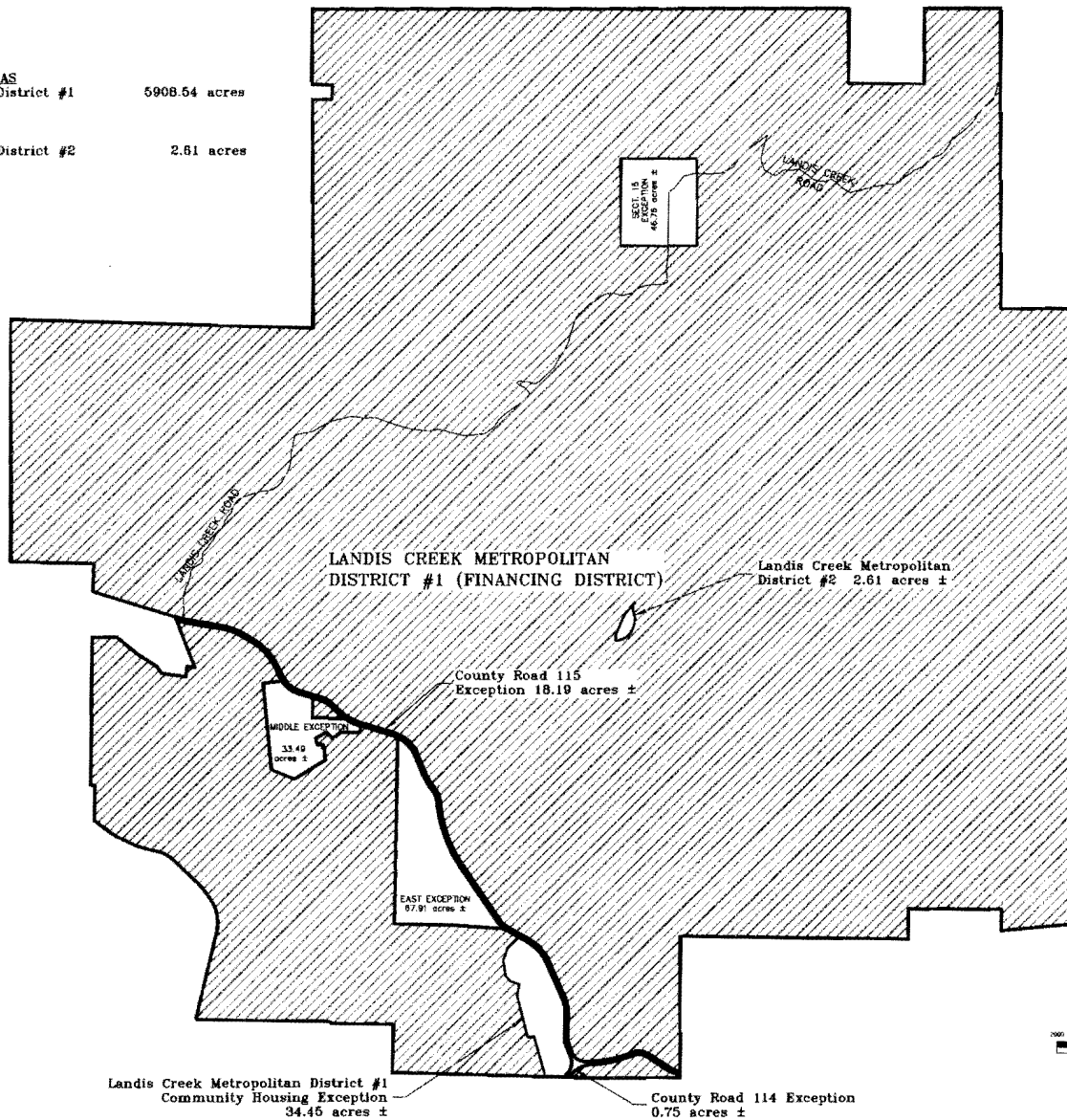

SHEET NO.

7

SPRING VALLEY RANCH P.U.D.
 Sections 14, 15, 16, 20, 21, 23, 26, 27, 28, 29, 32, 33 & 34
 Township 6 South, Range 20 West, 5th P.M.

GAMBA & ASSOCIATES, INC.
 CONSULTING ENGINEERS & LAND SURVEYORS
 1120 NORTH 30TH STREET, SUITE 1100, DENVER, COLORADO 80202



Landis Creek Metropolitan Districts

SCALE: 1" = 2,000'	DATE: January 14, 2010	DRAWN BY: top
SHEET: 1 of 1	PROJECT: 07288-19	CHECKED BY: mjh
DRAWING: Landis Creek Metropolitan Districts 20100114.dwg		
CHECKED BY: RUP12P111/Thomas Shaver		

